

CLAMP ELEMENT SCE201FH形

SCE201FH 19×47

規格型號

內徑 (mm) 外徑 (mm)

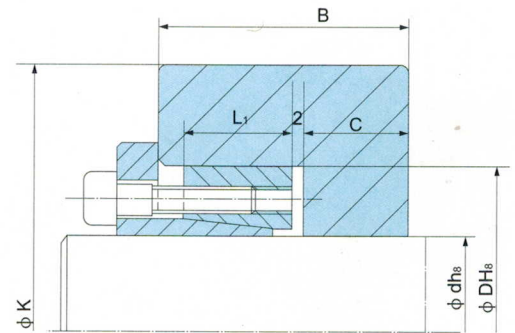
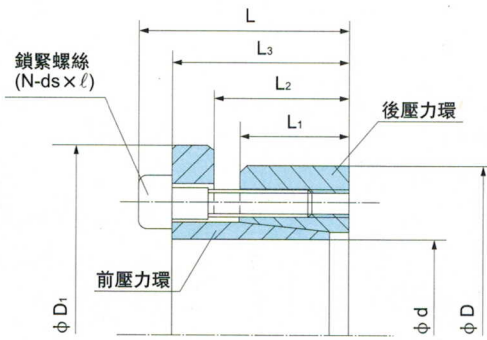

• 輪殼與軸相對應位置可完全固定，無軸向移動。

尺寸、性能 輪殼內徑表面受面壓 (P_B) 時的必要最小外徑 phi K (B ≥ 2 × L₁, C ≥ 1/2)

※(MPa)

規格	L mm	L ₃ mm	L ₂ mm	L ₁ mm	D ₁ mm	可傳遞力矩		面壓力		鎖緊螺絲			輪殼材料 σ _{0.2} 與 外徑 phi K 之最小值 (mm)						重量 g	J × 10 ⁻⁵ Kg·m ²
						扭力 (M) N·m	推力 (F) KN	軸 (P _s) MPa	孔 (P _B) Mpa	個數 (N)	尺寸 (ds × l)	扭力 (Ms) N.m	150※	200※	250※	300※	350※	400※		
SCE201FH d × D mm													FC250	FC350	FCD400	FCD450	FCD500	FCD600		
8 × 22	21	17	13	10	25	18	4.7	279	71	3	M4 × 15	3.9	33	30	28	27	26	26	45	0.33
9 × 23	"	"	"	"	26	21	"	248	68	"	"	"	34	31	29	28	27	27	50	0.38
10 × 24	"	"	"	"	27	30	6.2	300	87	4	"	"	40	35	32	31	30	29	53	0.45
11 × 25	"	"	"	"	28	34	"	270	84	"	"	"	41	36	33	32	31	30	56	0.53
12 × 26	"	"	"	"	29	47	7.8	310	100	5	"	"	48	40	37	35	33	32	60	0.63
13 × 27	"	"	"	"	30	50	"	286	97	"	"	"	48	41	38	36	34	33	63	0.70
14 × 31	26	21	16	12.5	34	70	10.0	266	87	4	M5 × 15	8.0	52	45	42	40	38	37	100	1.45
15 × 32	"	"	"	"	35	75	"	248	84	"	"	"	52	46	43	41	39	38	105	1.63
16 × 33	"	"	"	"	36	80	"	232	81	"	"	"	53	47	44	42	40	39	110	1.88
17 × 34	"	"	"	"	37	105	12.5	273	99	5	"	"	62	52	48	45	43	42	115	2.05
18 × 35	"	"	"	"	38	110	"	258	96	"	"	"	62	53	49	46	44	43	120	2.25
19 × 47	38	32	24	20	53	290	30.0	290	94	6	M6 × 25	16	82	70	65	61	59	57	355	12
20 × 47	"	"	"	"	"	300	"	275	"	"	"	"	"	"	"	"	"	"	350	12
22 × 47	"	"	"	"	"	330	"	250	"	"	"	"	"	"	"	"	"	"	335	12
24 × 50	"	"	"	"	56	420	34.5	267	103	7	"	"	93	78	71	67	64	62	380	15
25 × 50	"	"	"	"	"	440	"	257	"	"	"	"	"	"	"	"	"	"	370	15
28 × 55	"	"	"	"	62	480	"	229	94	"	"	"	96	82	76	72	69	67	440	22
30 × 55	"	"	"	"	"	520	"	214	"	"	"	"	"	"	"	"	"	"	425	22
32 × 60	"	"	"	"	68	710	44.5	258	110	9	"	"	118	97	87	82	78	76	510	32
35 × 60	"	"	"	"	"	780	"	236	"	"	"	"	"	"	"	"	"	"	475	31
38 × 65	"	"	"	"	73	850	"	217	102	"	"	"	120	101	92	86	83	80	550	42
40 × 65	"	"	"	"	"	900	"	206	"	"	"	"	"	"	"	"	"	"	520	40
42 × 75	48	40	29	24	83	1730	82.0	305	135	"	M8 × 30	39	186	138	120	110	104	99	955	94
45 × 75	"	"	"	"	"	1850	"	284	"	"	"	"	"	"	"	"	"	"	900	92
48 × 80	"	"	"	"	88	1980	"	267	127	"	"	"	183	141	124	114	108	104	1010	115
50 × 80	"	"	"	"	"	2060	"	256	"	"	"	"	"	"	"	"	"	"	950	115
55 × 85	"	"	"	"	94	2520	91.0	258	132	10	"	"	204	153	134	123	117	112	1060	144
60 × 90	"	"	"	"	99	2750	"	237	125	"	"	"	202	156	138	128	121	117	1130	174
65 × 95	"	"	"	"	104	3570	110	263	142	12	"	"	256	181	156	142	134	128	1220	208
70 × 110	62	52	37	30	119	5040	144	264	129	10	M10 × 40	75	256	195	171	158	150	144	2280	505
75 × 115	"	"	"	"	124	5400	"	246	123	"	"	"	253	198	175	162	154	148	2400	588
80 × 120	"	"	"	"	129	5750	"	230	118	"	"	"	252	201	179	167	159	153	2520	680
85 × 125	"	"	"	"	134	7340	170	260	136	12	"	"	314	231	200	183	173	166	2660	788
90 × 130	"	"	"	"	139	7750	"	246	130	"	"	"	306	232	203	189	177	170	2780	920
95 × 135	"	"	"	"	144	9550	200	272	147	14	"	"	388	266	225	205	192	183	2980	1030
100 × 145	74	64	46	39	154	10800	216	199	113	15	"	"	292	237	212	198	189	183	4300	1720

*傳遞扭力與推力為最大值。 *輪殼外徑最小值， phi K 不含安全係數。