

CLAMP ELEMENT SCE201SH形

SCE201SH 19×47
 規格型號 內徑 (mm) 外徑 (mm)

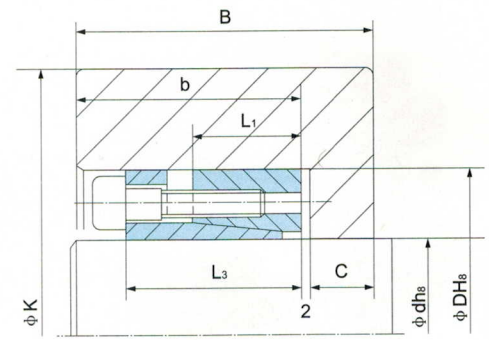
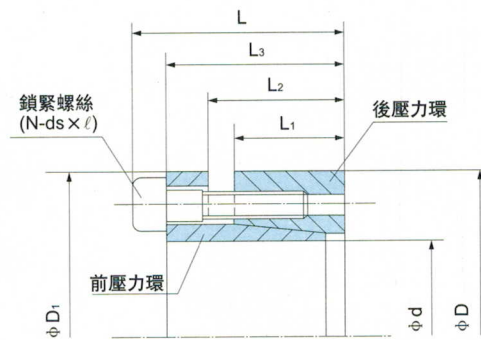

• 輪殼與軸接觸面聯結組立時，輪殼與軸安裝位置會有少許相對應移動。

尺寸、性能 輪殼內徑表面受面壓 (P_B) 時的必要最小外徑 phi K. (B ≥ 2 × L₁, b ≥ L₃, C ≥ 1/2)

※ (MPa)

規格	L mm	L ₃ mm	L ₂ mm	L ₁ mm	D ₁ mm	可傳遞力矩		面壓力		鎖緊螺絲		輪殼材料 σ ₀₂ 與 外徑 φ K 之最小值 (mm)						重量 g	J × 10 ⁻⁵ Kg·m ²	
						扭力 (M) N·m	推力 (F) KN	軸 (Ps) MPa	孔 (P _B) Mpa	個數 (N)	尺寸 (ds × l)	扭力 (Ms) N.m	150※	200※	250※	300※	350※			400※
SCE201SH d × D mm												FC250	FC350	FCD400	FCD450	FCD500	FCD600			
												SS400	SS490							
												SC410	SC480							
												S10C-NS	S20C-N	S35C-N	S45C-N	S55C-N				
19 × 47	38	32	24	20	46	300	31.0	304	98	4	M6 × 25	16	72	64	60	58	56	55	325	10
20 × 47	"	"	"	"	"	310	"	288	"	"	"	"	"	"	"	"	"	"	315	10
22 × 47	"	"	"	"	"	340	"	262	"	"	"	"	"	"	"	"	"	"	305	10
24 × 50	"	"	"	"	49	470	39.0	300	115	5	"	"	83	72	67	64	62	60	345	13
25 × 50	"	"	"	"	"	490	"	288	"	"	"	"	"	"	"	"	"	"	335	13
28 × 55	"	"	"	"	54	550	"	257	105	"	"	"	87	77	72	69	66	65	395	19
30 × 55	"	"	"	"	"	590	"	240	"	"	"	"	"	"	"	"	"	"	375	18
32 × 60	"	"	"	"	59	750	46.5	270	115	6	"	"	99	86	80	76	74	72	455	26
35 × 60	"	"	"	"	"	820	"	247	"	"	"	"	"	"	"	"	"	"	420	25
38 × 65	"	"	"	"	64	890	"	227	106	"	"	"	103	91	85	81	79	77	490	35
40 × 65	"	"	"	"	"	930	"	216	"	"	"	"	"	"	"	"	"	"	465	34
42 × 75	48	40	29	24	74	1810	86.0	319	142	"	M8 × 30	39	143	119	107	101	97	94	855	79
45 × 75	"	"	"	"	"	1940	"	298	"	"	"	"	"	"	"	"	"	"	795	77
48 × 80	"	"	"	"	79	2070	"	279	133	"	"	"	145	123	112	106	101	98	905	98
50 × 80	"	"	"	"	"	2160	"	268	"	"	"	"	"	"	"	"	"	"	860	96
55 × 85	"	"	"	"	84	2770	100	284	146	7	"	"	166	136	123	115	110	107	935	120
60 × 90	"	"	"	"	89	3020	"	260	138	"	"	"	168	140	127	120	115	112	1000	146
65 × 95	"	"	"	"	94	3740	115	275	149	8	"	"	189	154	139	130	124	120	1070	178
70 × 110	62	52	37	30	108	5540	158	290	142	7	M10 × 40	75	210	174	157	148	142	137	2060	434
75 × 115	"	"	"	"	114	5940	"	270	135	"	"	"	211	177	161	152	146	142	2170	512
80 × 120	"	"	"	"	119	6330	"	254	130	"	"	"	214	182	166	157	151	147	2280	592
85 × 125	"	"	"	"	124	7690	180	273	143	8	"	"	240	198	179	168	161	156	2400	688
90 × 130	"	"	"	"	129	8140	"	258	137	"	"	"	241	202	183	173	166	161	2510	783
95 × 135	"	"	"	"	134	10740	225	305	165	10	"	"	299	233	206	191	181	174	2650	898
100 × 145	74	64	46	39	144	11300	"	209	118	"	"	"	243	210	194	185	179	174	3950	1535

*傳遞扭力與推力為最大值。 *輪殼外徑最小值，φ K不含安全係數。